

Specifications

A 备注 (Remark)

1. 材料 (MATERIAL)

胶芯: PA6T+30%G, F UL94V-0, 颜色: 兰色.

Housing: PA6T/+30%G, F UL94V-0, Color: Blue

端子: 磷/青铜, 镀底30u"MIN, 表面镀金1u"MIN

Contact: Phosphor bronze, 1u"MIN GOLD PLATING OVER ALL

30u" MIN NICKEL UNDERPLATING OVER ALL

B 2. 特性 (characteristics):

额定电流: 3 AMP

Rated Current: 3 AMP.

接触电阻: 20 mΩ MAX.

Contact Resistance: 20 mΩ MAX.

绝缘阻抗: 1000 MΩ MIN.

Insulating Resistance: 1000 MΩ MIN.

耐电压: AC 500V.

Withstanding Voltage: AC 500V.

温度范围: -40°C to +105°C

Temperature Range: -40°C to +105°C

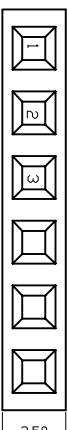

Ordering Information

F185-21 06 A1 B SY C 2

NO. OF PINS PER ROW	INSULATOR MATERIAL:	PACKAGING
2-40P	A: PBT	A: PE Bag
	B: PA6T	B: Tape & Reel
	C: PA9T	C: Tube+CAP
	D: LCP	E: Tray

NO. OF PINS PER ROW	Contact Plating	INSULATOR MATERIAL:	PACKAGING
Full Of gold	Semi-gold	A: PBT	A: PE Bag
A0=0.8u"	B0=0.8u"	B: PA6T	B: Tape & Reel
A1=1u"	B1=1u"	C: PA9T	C: Tube+CAP
A2=1.5u"	B2=1.5u"	D: LCP	E: Tray
A3=2u"	B3=2u"		
A4=3u"	B4=3u"		
A5=5u"	B5=5u"		
A6=10u"	B6=10u"		
A7=15u"	B7=15u"		
A8=20u"	B8=20u"		
A9=30u"	B9=30u"		
S1=Ordinary Tin Plated	S2=Matte Tin Plated		
S3=Trim-plated High-Temperature			

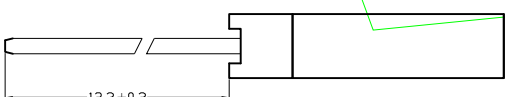
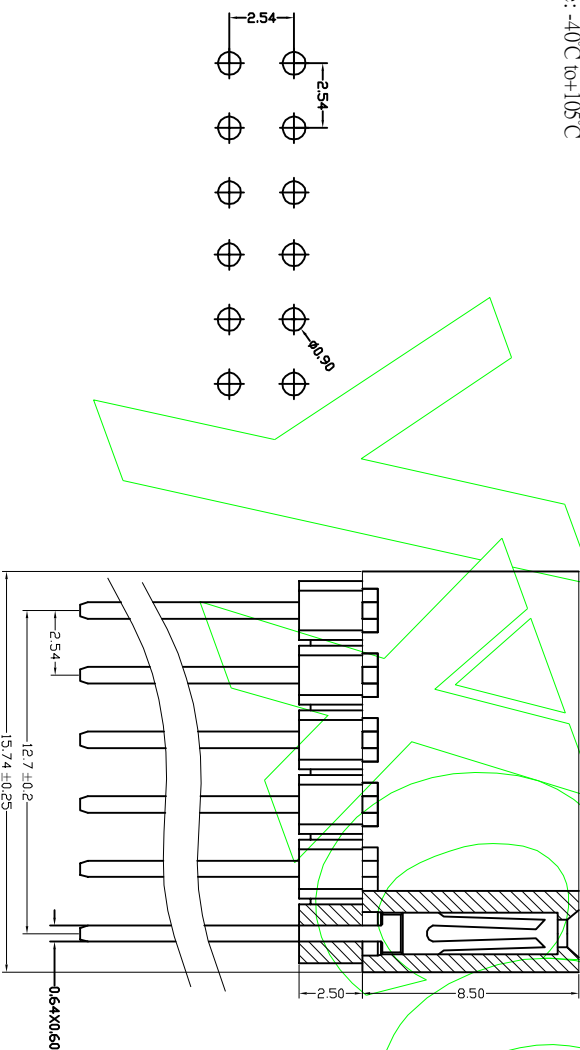

REV	DATE	MODIFICATION DESCRIPTION	CHANGE	APPROVE	OPERATION		SCALE		Fit	DESIGN	CHECK	PART NO.	TITLE:
					X.X	±0.25	UNIT	MM					
					X.XX	±0.20	A4			丘康乐		F185-2203A1BSYC2	2.54mm 双排母 间距8.5 加2.5 146P 180度 Y型 PC104
					X.XXX	±0.10	SHEET	1/1					
					Angle	±3°	PROJ.						
					DIM	TOL.							Customer No.



东莞市宇熙精密连接器有限公司
Dongguan Yuxi Electronic Co., Ltd.