

Specifications

A 备注 (Remark)

1. 材料 (MATERIAL)

底座: PA6T/PBT+30%G, F UL94V-0, 颜色: 黑色,

Housing: PA6T/PBT+30%G, F UL94V-0, Color: Black

端子: 磷/青铜, 镀底30u"MIN, 表面镀金1u"MIN

Contact: Phosphor bronze, 1u"MIN GOLD PLATING OVER ALL

30u" MIN NICKEL UNDERPLATING OVER ALL

2. 特性 (characteristics):

额定电流: 3 AMP

Rating Current: 3 AMP.

接触阻抗: 20 mΩ MAX.

Contact Resistance: 20 mΩ MAX.

绝缘阻抗: 1000 MΩ MIN.

Insulating Resistance: 1000 MΩ MIN.

耐电压: AC 500V.

Withstanding Voltage: AC 500V.

温度范围: -40°C to +105°C

Temperature Range: -40°C to +105°C

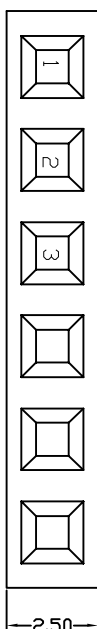

NO. OF PINS PER ROW 1-40P

Contact Plating: Full of gold, Semi-gold

INSULATOR MATERIAL: A: PE Bag, B: Tape & Reel, C: Tube, D: Tube+Cap, E: Tray

A0=0.8u", A1=1u", A2=1.5u", A3=2u", A4=3u", A5=5u", A6=10u", A7=15u", A8=20u", A9=30u"

B0=0.8u", B1=1u", B2=1.5u", B3=2u", B4=3u", B5=5u", B6=10u", B7=15u", B8=20u", B9=30u"

S1=Ordinary Tin Plated, S2=Matte Tin Plated, S3=Tin-plated High-Temperature

Ordering Information

F185-11 06 A1 B SY C 1

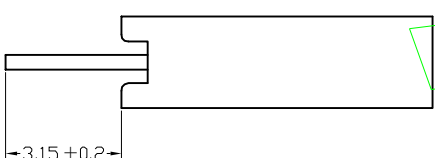
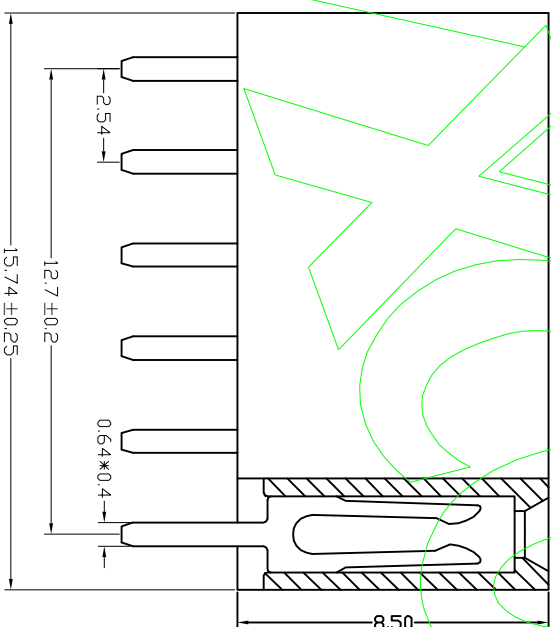

东莞市宇熙精密连接器有限公司
Dongguan Yuxi Electronic Co., Ltd.

丘康乐

PART NO. F185-1106A1BSYC1

TITLE: 2.54mm 单排母 间距8.5 180度 1*6P Y型 黑色

REV	DATE	MODIFICATION DESCRIPTION	CHANGE	APPROVE	OPERATION		SCALE		Fit	DESIGN	CHECK	APPROVE	PROJ.	DIM	TOL.	SHEET	1/1	SHEET	ANGLE	DIM	TOL.	
					X.X	±0.25	UNIT	MM														
					X.X	±0.20	A4															
					X.XXX	±0.10																
					Angle	±3°																

1 2 3 4 5 6 7 8 9 10